

Mobile IR Wedge Camera

Interior or exterior wedge camera for mobile applications



NDAA Compliant

The **Mobile IR Wedge Camera** from March Networks® provides flexible mounting options — both interior and exterior — for vehicles deploying cameras. The ruggedized housing protects the camera from dust and moisture, and its vandal-resistant aluminum design, with polycarbonate dome cover, is built to withstand the harsh transit environment of bus and rail vehicles, including wide temperature swings and humidity.

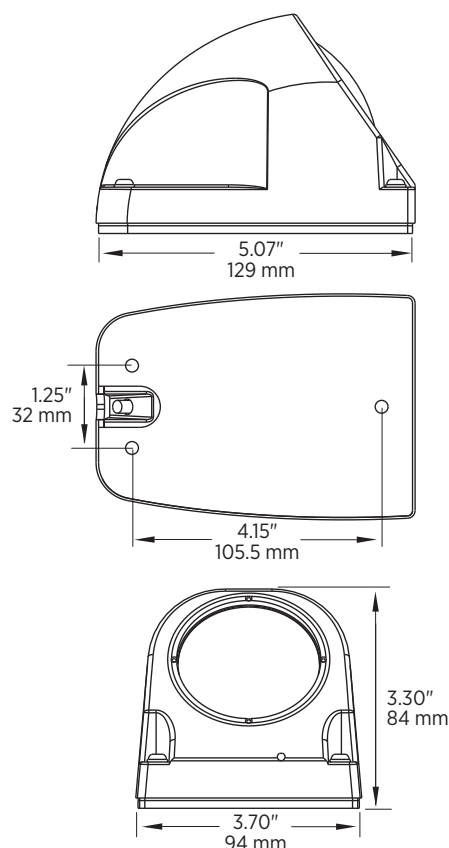

Key Benefits

- ▼ **Perfect field of view.** The wedge form factor, combined with a 2.9 or 3.6mm lens, delivers the ideal angle for curbside or road side surveillance.
- ▼ **See clear images in the dark.** The camera's True day/night capabilities and dual high-powered IR LEDs provide clear video, even when the vehicle's lights are off.
- ▼ **3-axis gimbal.** The camera's pan, tilt and rotation are adjusted by a single mechanism. This allows for single-handed positioning of the camera during installation and simplifies setup.
- ▼ **Condensation protection.** The camera contains a membrane that prevents moisture from permeating and also allows moisture to escape, giving it breathability and protecting the camera.
- ▼ **Wide temperature ranges.** To ensure the camera is reliable in all-seasons, it can withstand temperatures as low as -13°F (-25°C), and as high as to 131°F (55°C).

Get clear views of what's happening inside and outside the vehicle in all conditions.

Mobile IR Wedge Camera (Interior or Exterior)

CAMERA	
Image Sensor	1/3" CMOS WDR, 2D-DNR, flicker automatic cancellation
Wide Dynamic Range	120dB
Lens	Fixed M12, f1.2, 2.9mm or 3.6mm fixed lens
Day/Night	Automatic IR Cut Filter
IR LED	ON/OFF mechanical switch
Minimum Illumination	Color: 0.16 lux; B/W: 0.08 lux; B/W with IR: 0 lux
Signal-to-Noise Ratio	43dB
Shutter Time: NTSC	1/60s – 1/16000s
PAL	1/50s – 1/16000s
Sync System	Internal
VIDEO	
Effective Pixel Count	550(H) x 450(V)
Horizontal Resolution	650 TVL
Image Settings	Optimized for in-vehicle operation

ELECTRICAL	
Power	DC 12 V
Power Consumption	Typical 1.9W, 2.75W (with IR on)
GENERAL	
Construction	Polycarbonate transparent cover Vandal-resistant aluminum housing (available in black or white) IP66*
Connectors	BNC
Operating Conditions	-22° to 131°F / -30° to 55°C <90%, non-condensing
Storage Temperature	-40° to 158°F / -30° to +70°C
Weight	1.3 lbs / 0.58 Kg
Included Accessories	Mounting template, mounting screws, installation screwdriver, BNC video out cable
REGULATORY	
EMC	EN55032, FCC Part 15 Subpart B, ICES-003, CISPR 32, AS/NZS CISPR 32, EN50130-4
Shock/Vibration	MIL-STD-810, SAE J1455
Others	ROHS, WEEE

ORDERING INFORMATION	
WHITE HOUSING	
31318-101	Mobile IR Wedge Camera (2.9mm lens)
31320-101	Mobile IR Wedge Camera (3.6mm lens)
BLACK HOUSING	
31314-101	Mobile IR Wedge Camera (2.9mm lens)
31315-101	Mobile IR Wedge Camera (3.6mm lens)

*IP66 compliance requires installation as per March Networks guidelines in the product installation manual.