

SE2 Fleet Dash Camera

2MP camera with LED Flicker Mitigation (LFM)
and High Dynamic Range (HDR)



NDA compliant



The March Networks® **SE2 Fleet Dash Camera** delivers high-quality video in the most challenging lighting conditions, including near darkness and bright sunlight, for rugged bus and rail deployments. The camera's powerful combination of HDR, plus LED Flicker Mitigation, renders it the perfect solution for transit agencies requiring a ruggedized forward facing camera that captures exceptionally clear images and delivers flexible mounting options.



HD image captured with the
SE2 Fleet Dash Camera

Key Benefits

- ▼ **Eliminate LED Flicker.** LED Flicker Mitigation (LFM) suppresses the “strobing” generated by vehicles, traffic lights, and electronic signs that use LED light sources.
- ▼ **Traffic light/rail signal color mode.** The camera provides color images in low light conditions to capture traffic light or rail signal information.
- ▼ **Transit tough.** The camera complies with SAE J1455 and EN50155 ratings to handle shock and vibration in rugged vehicle applications. It is also vandal-resistant (IK10) and protected from dust and humidity (IP67).
- ▼ **Anti-glare cone.** Eliminates light reflections coming from inside the vehicle.
- ▼ **High Dynamic Range (HDR).** The camera blends the best parts of multiple exposures into a single image, which is necessary for vehicles entering or exiting tunnels, or driving towards direct sunlight.
- ▼ **Wide temperature ranges.** To ensure the camera is reliable in all-seasons, it can withstand temperatures as low as -13°F (-25°C), and as high as to 131°F (55°C).
- ▼ **QR code.** Use the March Networks GURU smartphone app to scan the camera's QR code for instant product information, like serial number, warranty information, etc.

*Get glare-free, high-quality video — with no flicker —
through the vehicle's windshield, in both direct
sunlight and near-dark conditions.*

SE2 Fleet Dash Camera

CAMERA

Image Sensor	1/3" CMOS with LFM
Dynamic Range	120dB
Lens	4mm, F1.6 fixed lens
Field of View	88° horizontal, 47° vertical
Day/Night	Automatic IR Cut Filter
Minimum Illumination	Color: 0.12 Lux @ F1.6
Shutter Time	Up to 30ms

VIDEO

Video Compression	H.264 (MPEG-4 Part 10/AVC)
Resolution	2MP (1920 x 1080), SXGA, 720p, XGA, SVGA, D1, VGA, CIF
Frame Rate	Up to 30fps @ 2MP (1920x1080)
Video Streaming	Quad-stream H.264 (full resolution on stream 1 and stream 2) Controllable frame rate and bandwidth CBR/VBR/LBR Up to two simultaneous streams with any combination of resolution and frame rate
Image Settings	Brightness, sharpness, contrast, saturation, hue, exposure control, white balance control, digital zoom, dynamic range control, 3D noise reduction, mirroring of images

ORDERING INFORMATION

38313-101	SE2 Fleet Dash Camera, RJ45 connector
38313-102	SE2 Fleet Dash Camera, M12 connector

GENERAL

Construction Camera	Polycarbonate transparent cover Black powder-coated aluminum housing
Environmental	IP67, IK10
Mounting Brackets	Black powder-coated steel
Power	Power over Ethernet IEEE 802.3af Class 3
Power Consumption	5W
Connectors	RJ45 or M12 4-pin
Local Storage	microSD/microSDHC/microSDXC memory card up to 64GB (card sold separately)
Operating Conditions	-13° to 131°F / -25° to 55°C Humidity 8 – 90% RH, non-condensing
Certification Model	C2002A
Regulatory Approvals	EN55032, CISPR 25, FCC Part 15 Subpart B; ICES-003, EN50155; EN50130-4; EN 50121-3-2; SAE J1113
Environmental Directive Compliance	ROHS2 Directive 2011/65/EU and amendment (EU) 2015/863, WEEE Directive 2012/19/EU
Shock/Vibration	SAE J1455, EN50155 (IEC 61373)
Camera Weight	1.86 lbs (0.84 Kg) with Mount and Long Extender Bracket
Included Accessories	Anti-glare cone, mount, long extender bracket, Allen key, mounting screws
Optional Accessories	32605 short extender brackets (2.4 in / 61.25 mm) — in package of 10 32606 Medium extender brackets (3.4 in / 86.62 mm) — in package of 10 36404 Sunshield (5 pack) — Affixes to the end of the camera to minimize windshield glare and reflection

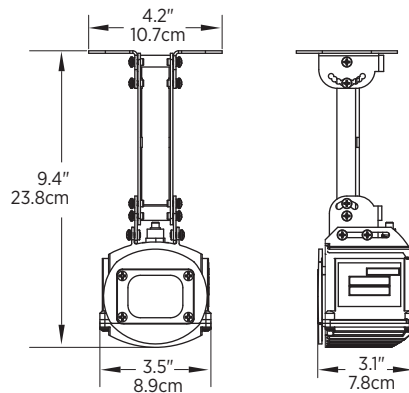

Camera shown with
9.4" extender bracket
(ships with camera)

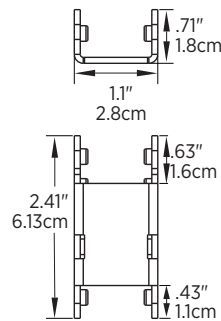

2.4" extender bracket
(reduces length from
9.4in/23.8cm to
6.4in/16.2cm)

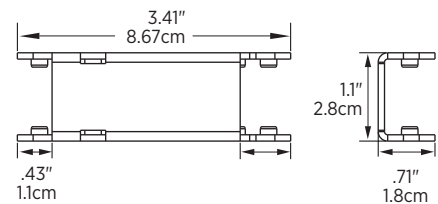

3.4" extender bracket (reduces length from
9.4in/23.8cm to 7.4in/18.7cm)